

DESIGN NARRATIVE

My proposed design of UCLA's Westwood entrance is meant to improve the area visually and experientially by enhancing shade and views for any observer through planting. As is, the site is heavily exposed to sun with little shade and lackluster planting that has gradually deteriorated over time. Taking advantage of UCLA's extensive existing plant palette and its value for research I utilized trees and shrubs already seen around campus or Los Angeles. My primary intention is to formalize this entrance to campus by flanking Westwood Blvd with double rows of *Washingtonia filifera*. Streets lined with avenues of towering palm trees are iconic to Los Angeles however not currently utilized elsewhere on campus. Previous designs of this entrance also employed flanking Westwood Blvd with trees like *Quercus agrifolia* or *Eucalyptus*, therefore I decided to incorporate both species as an homage to original designs. Planting arrangements compliment the trees both aesthetically and in terms of maintenance. Areas around the *Quercus* respect summer water restrictions and incorporate shrubs with inflorescence of UCLA's colors: Blue, White and Yellow. Around the *Eucalyptus deglupta*, I've incorporated colors commonly seen in its remarkable bark like Red, Green, and Yellow. Lastly, I've divided the large lawn parkways along Le Conte Ave with plant-lined pathways to redirect foot-traffic from planted areas and added more benches for an inviting break.

Sunset Zone: 22; USDA Hardiness Zone: 10B.

SITE ANALYSIS

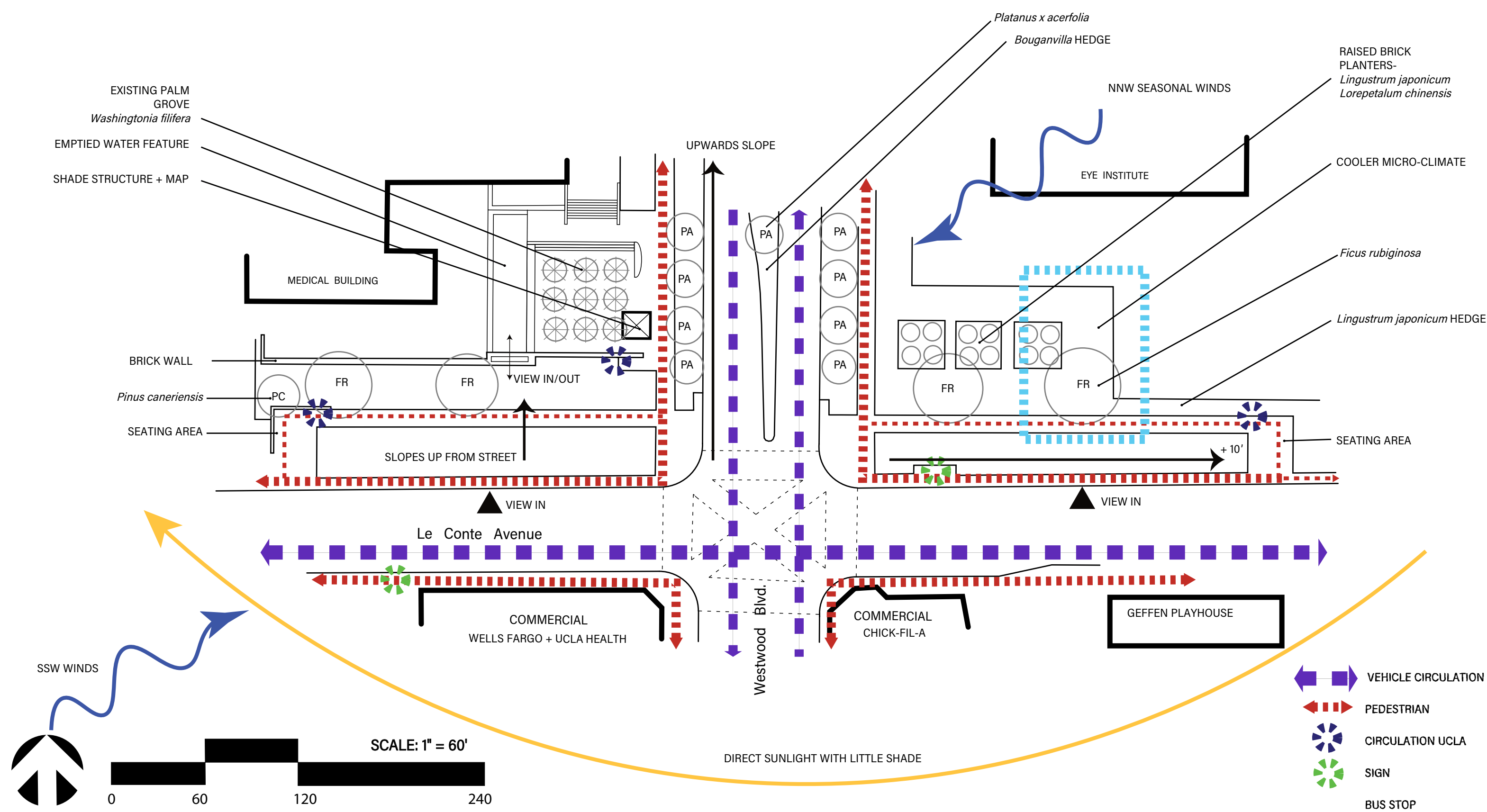

LEGEND + PLANT PALETTE

<ul style="list-style-type: none"> <i>Arbutus unedo</i> - Strawberry Madrone - 20 - 35'; 20 - 35'; Low, SWR <i>Eucalyptus deglupta</i> - Rainbow Eucalyptus - 100 - 125'; 60 - 80'; Low - High <i>Quercus agrifolia</i> - Coast Live Oak - 25 - 80'; 15 - 35'; Low, SWR <i>Washingtonia filifera</i> - California Fan Palm - 50 - 70'; 10 - 20'; Low - High <i>Ceanothus 'Concha'</i> - Concha Ceanothus - 6 - 8'; 8 - 10'; Low, SWR <i>Leymus condensatus 'Canyon Prince'</i> - Canyon Prince Wild Rye - 2 - 3'; Spreading; Low - Medium, SWR 	<ul style="list-style-type: none"> <i>Phormium tenax 'Radiance'</i> + 'Sea Jade' - New Zealand Flax - 4 - 6'; 4 - 6'; Low - Medium <i>Canna x generalis 'President'</i> + 'Tropical Yellow' - 4 - 6'; 3 - 4'; Medium <i>Phlomis fruticosa</i> - Jerusalem Sage - 3 - 4'; 3 - 4'; Low, SWR <i>Agapanthus praecox orientalis</i> spp. 'Getty White' + 'Silver Streak' - <i>Agapanthus</i> - 1-2'; 1-2'; Low - Medium <i>Anigozanthos hybrid</i> - 'Big Red' + 'Bush Dawn' - 4-6'; 2-3'; Medium <i>Asparagus densiflorus 'Myers'</i> - Foxtail Ferns - 1-2'; 1-2'; Medium 	<ul style="list-style-type: none"> <i>Clivia miniata 'San Marcos Yellow'</i> - Select Yellow Clivia - 2'; 2'; Low - Medium <i>Lantana montevidensis</i> spp. 'Alba' + 'New Gold' - Trailing Lantana - 1-2'; 4-6'; Low, SWR Container: <ul style="list-style-type: none"> <i>Aloe greenii</i> - Icena Aloe - 1-2'; Spreading; Low, SWR <i>Rosmarinus officinalis 'Irene'</i> - Trailing Blue Rosemary - 2-3'; 6-8'; Low, SWR <i>Trachelospermum jasminoides</i> - Star Jasmine - 2-6'; Spreading, Medium <i>Carex praegracilis</i> - California Field Sedge - <1'; Spreading; Low - Medium
--	--	--